

STANDARD MOUNTING PARTS TO PACKAGE AND SHIP

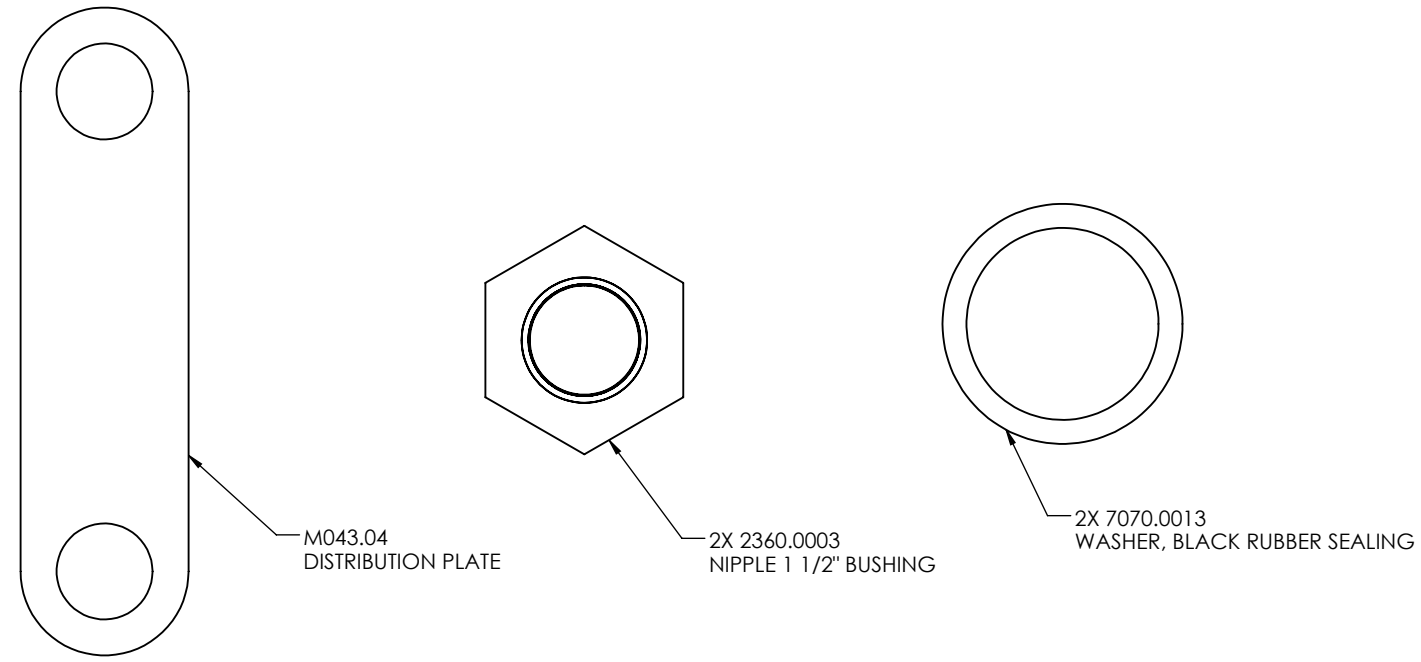

OPT1 MOUNTING PARTS TO PACKAGE AND SHIP

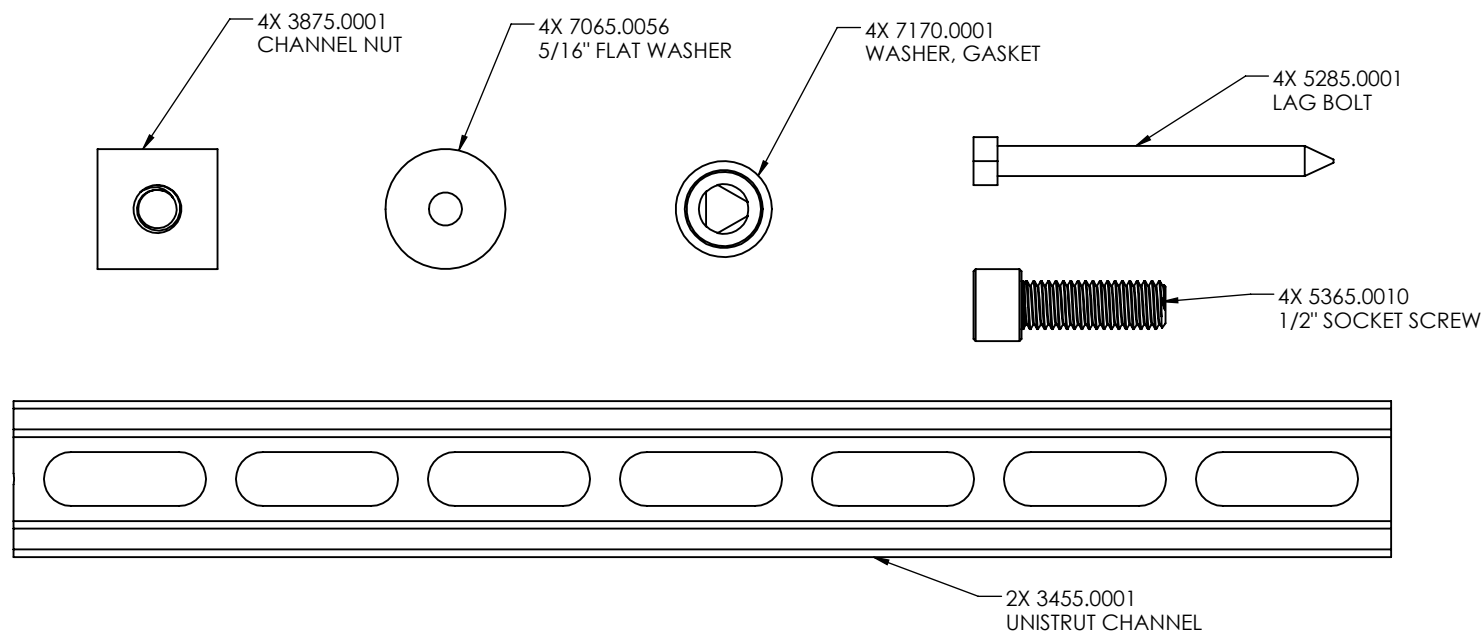

Notes:

1. See BOM as provided by PCB Engineering.
2. All equivalencies must be approved by PCB Engineering.
3. All components and processes must be ROHS compliant.

REV.	DESCRIPTION	DATE	BY	ECO
A	INITIAL RELEASE	12/18/2017	D. WILDING	4651
B	CHANGED SCREW PART NUMBER	1/8/2018	D. WILDING	4670
C	LITHIUM CHARGE CONTROLLER	3/19/2020	D. ANDERSON	4963

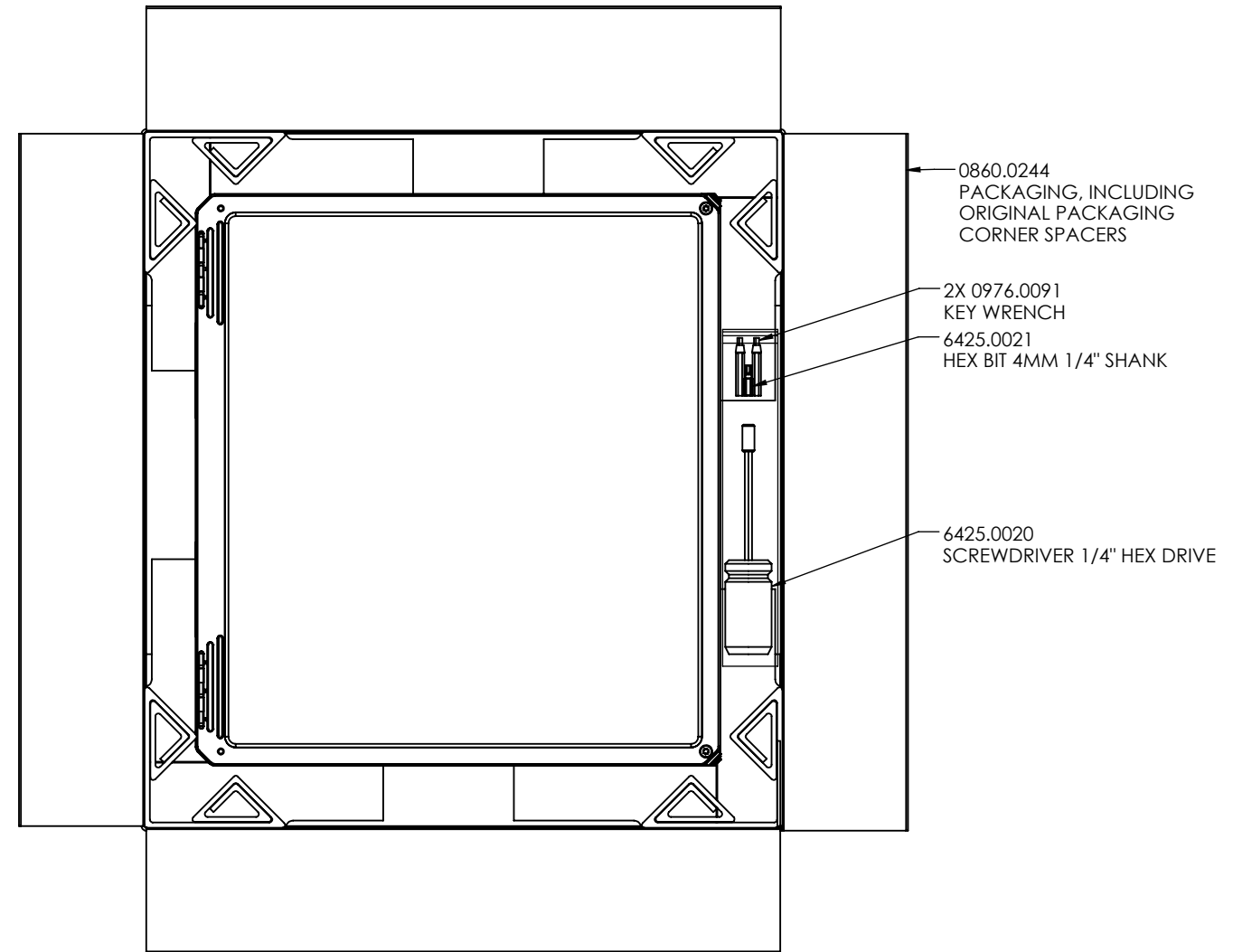

PACKAGING INSTRUCTIONS:

1. SHIP THE SURGE SUPPRESSOR IN THE ORIGINAL PACKAGING FOR -AC SYSTEMS.
2. PACKAGE ACCESSORIES AND SURGE SUPPRESSOR INTO A 0860.0241 BOX AND SHIP INSIDE THE CASE.
3. BAG THE 2X 0976.0091 KEY WRENCH AND THE 6425.0021 4MM HEX BIT. TAPE BAG IN BOX FOR THE 6425.0020 SCREWDRIVER AND PLACE INTO CASE.

PCB PIEZOTRONICS
Provo, Utah, USA (801) 375-0177

TITLE: **BOX ASSEMBLY**

TEMPLATE: D2140-0023 [1]

AUTHOR: D. ANDERSON
DATE: 11/7/2017

SIZE: **B** NUMBER: **EPS045** REV: **C**

SCALE: 1:6 SHEET 1 OF 6

PROPRIETARY AND CONFIDENTIAL THIS DOCUMENT, SUBMITTED IN CONFIDENCE, CONTAINS PROPRIETARY INFORMATION WHICH SHALL NOT BE REPRODUCED OR TRANSFERRED TO OTHER DOCUMENTS OR DISCLOSED TO OTHERS OR USED FOR ANY OTHER PURPOSE WITHOUT THE WRITTEN PERMISSION OF PCB PIEZOTRONICS, INC.

COPYRIGHT © PCB PIEZOTRONICS, INC. FILE NAME: EPS045 Box Assembly

STANDARD HOLE PATTERN

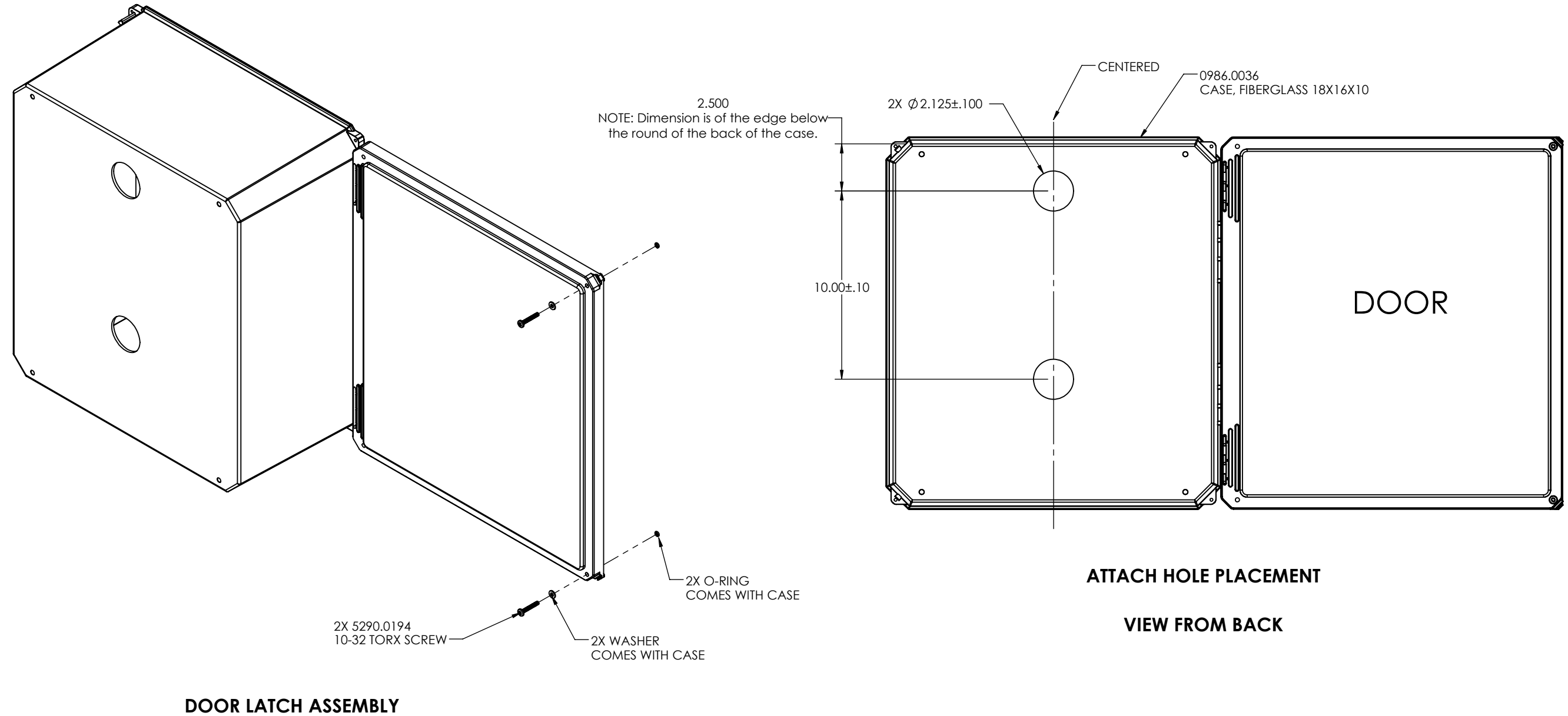

ASSEMBLY NOTES:

1. REMOVE THE SCREWS PROVIDED WITH THE CASE AND REPLACE WITH 5290.0194 TORX SCREWS
2. DRILL HOLES INTO BACK OF CASE

CHANNEL HOLE PATTERN (-OPT1)

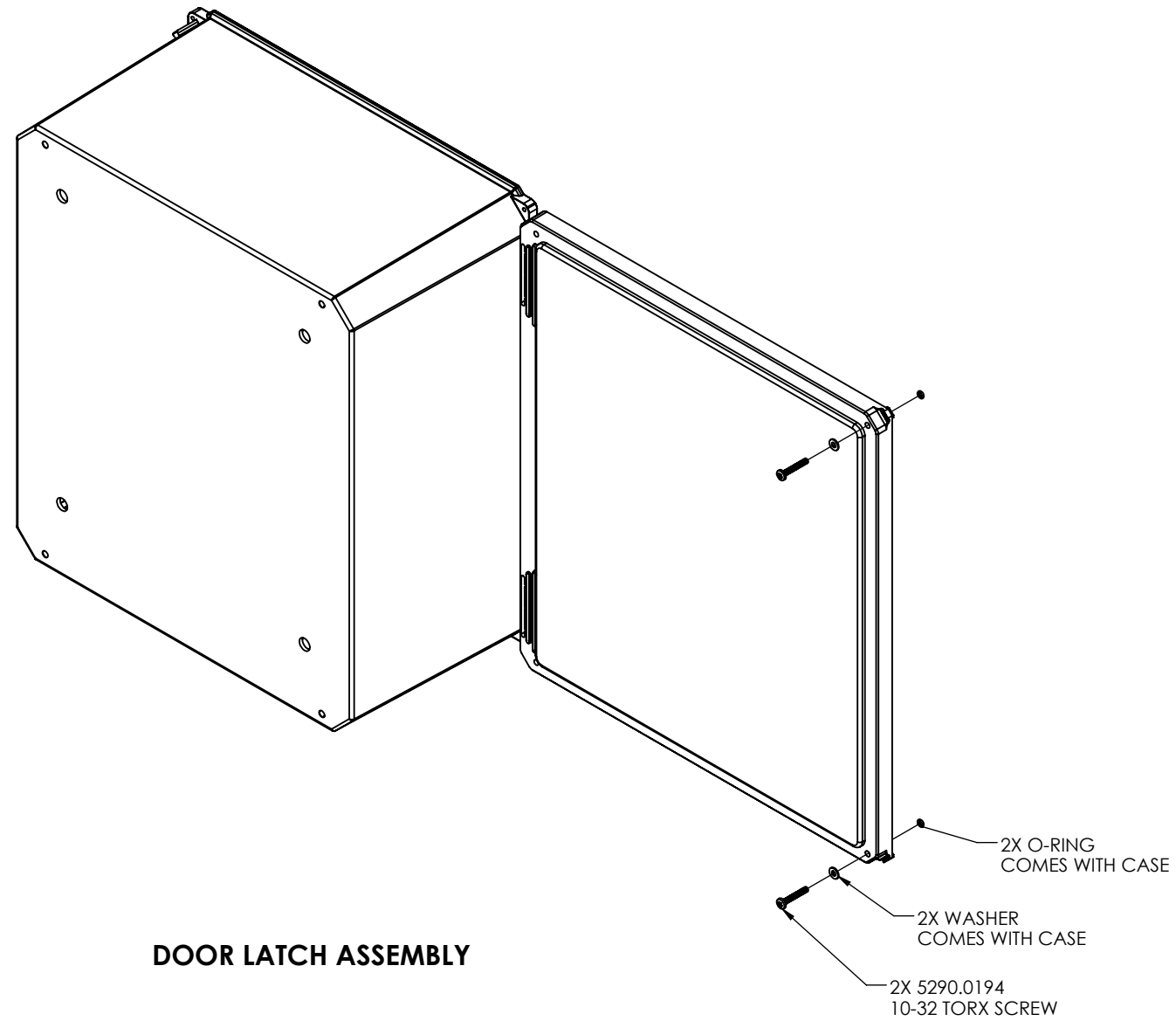

DOOR LATCH ASSEMBLY

NOTE: Dimensions are of the edge below the round of the back of the case.

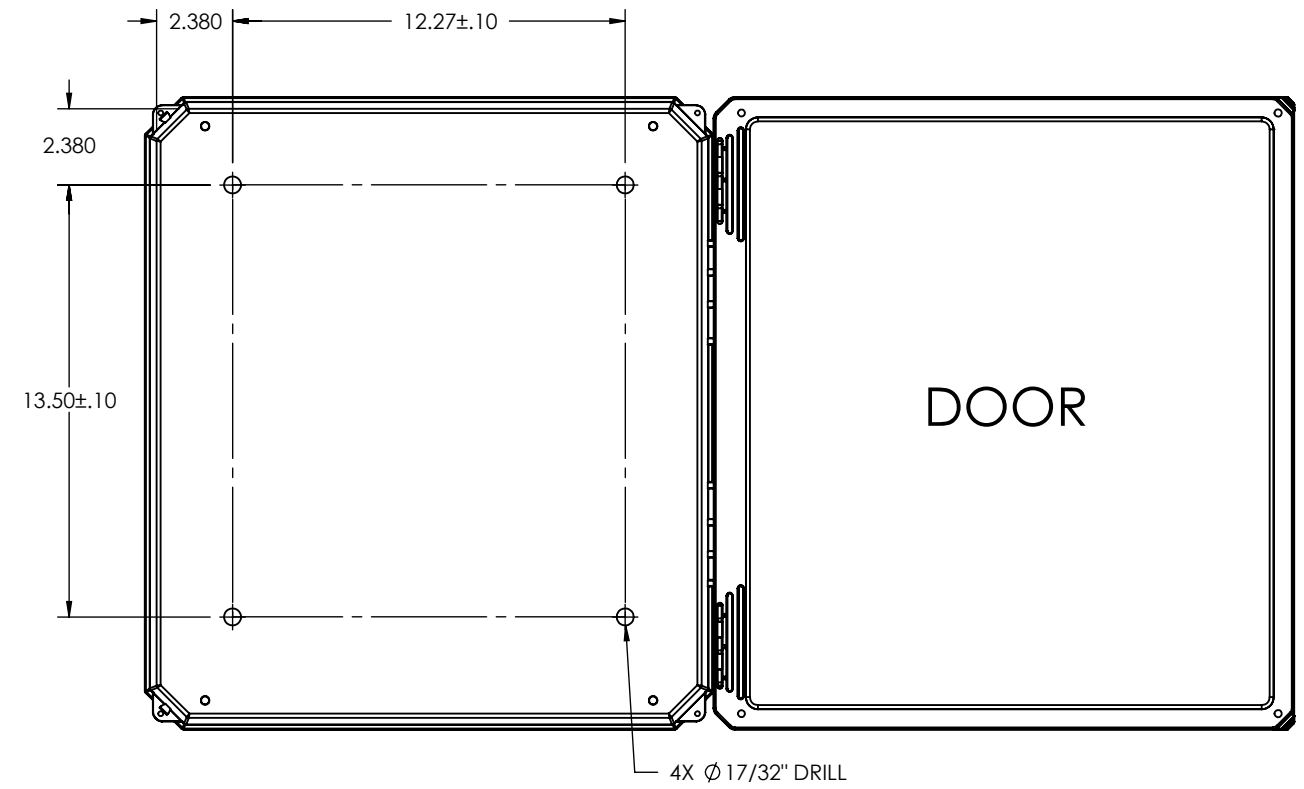

ATTACH HOLE PLACEMENT

VIEW FROM BACK

ASSEMBLY NOTES:

1. REMOVE THE SCREWS PROVIDED WITH THE CASE AND REPLACE WITH 5290.0194 TORX SCREWS
2. DRILL HOLES INTO BACK OF CASE

MAGNETIC SWITCH PLACEMENT

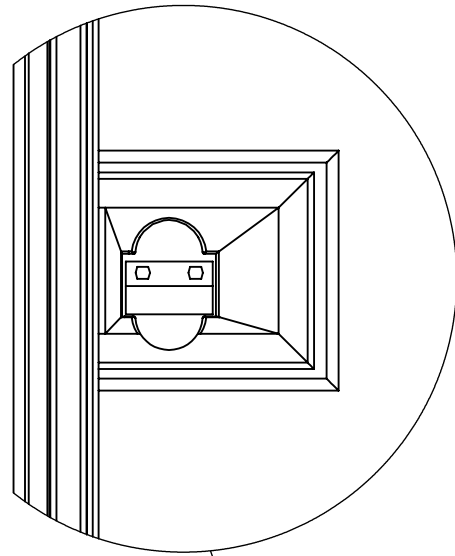

PLACEMENT OF THE MAGNET SENOR

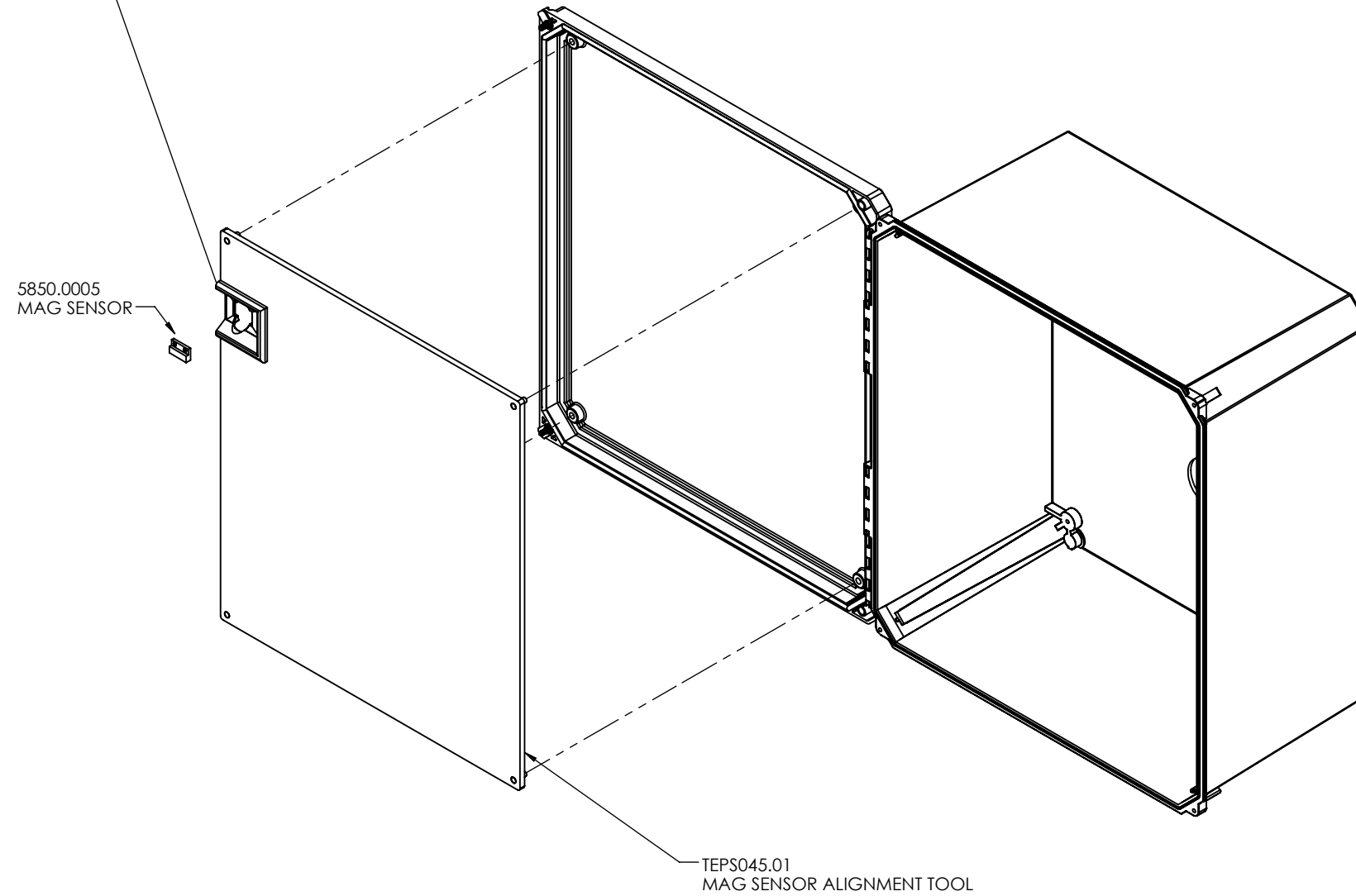
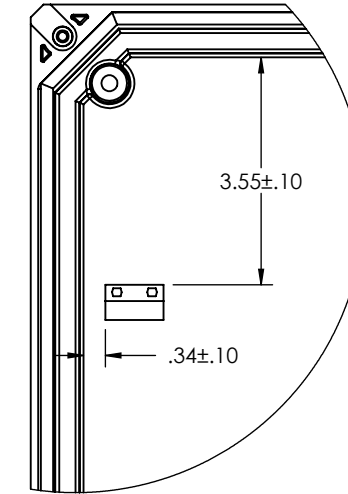

ASSEMBLY NOTES:

1. PRIOR TO ASSEMBLY, CLEAN THE INSIDE OF THE DOOR WITH ALCOHOL TO ENSURE A CLEAN SURFACE.
2. ALIGN THE TEPS045.01 TOOL WITH THE HOLES IN THE DOOR AND PUT IN PLACE.
3. SPREAD THE 0220.0016 EPOXY ON THE BACK OF THE 5850.0005 MAG SENSOR.
4. PLACE THE 5850.0005 MAG SENSOR WITH THE MOUNT HOLES ON THE TOP. PUSH INTO THE EPOXY TO SET IN PLACE. FILL THE MOUNTING HOLES OF THE MAG SENSOR WITH EPOXY FOR ADDED ADHESION.
5. REMOVE THE TOOL AND CAREFULLY CLEAN UP ANY EPOXY WHICH IS NOT TIDY WHILE NOT DISTURBING THE SENSOR PLACEMENT.

AC POWER SYSTEM

SHELF ASSEMBLY

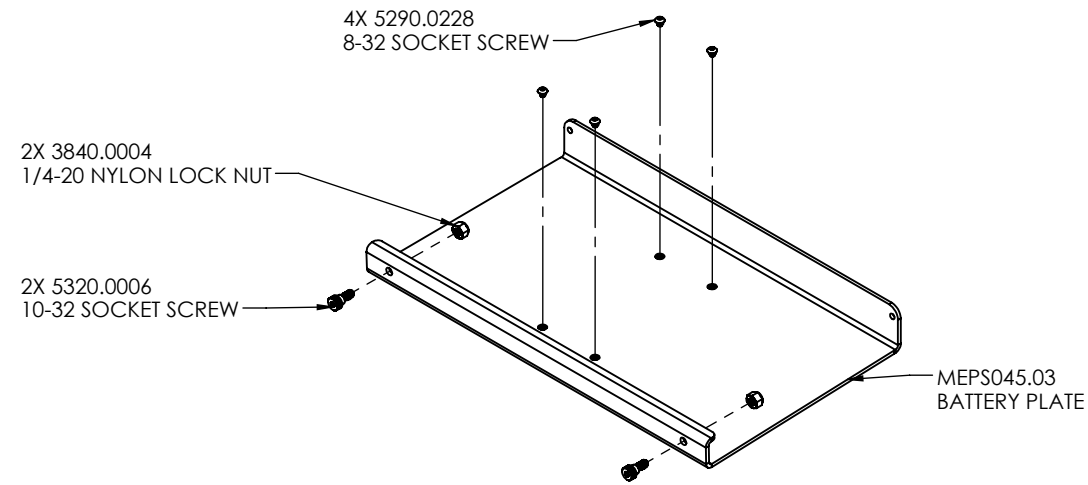

SHELF ASSEMBLY NOTES:

1. ASSEMBLE THE 5290.0228 SCREWS TO THE BATTERY PLATE USING THE T043.01 HOLE PATTERN TOOL AND RED LOCTITE TO FIX THE SCREW HEIGHT. THIS PROVIDES PROPER SPACING FOR THE SURGE SUPPRESSOR.
2. THREAD THE TWO 5320.0006 SHOULDER SCREWS THROUGH THE BATTERY PLATE AND LOCK IN PLACE WITH THE 3840.0004 NYLON LOCK NUT. TIGHTEN HAND TIGHT.

BACKPLATE ASSEMBLY

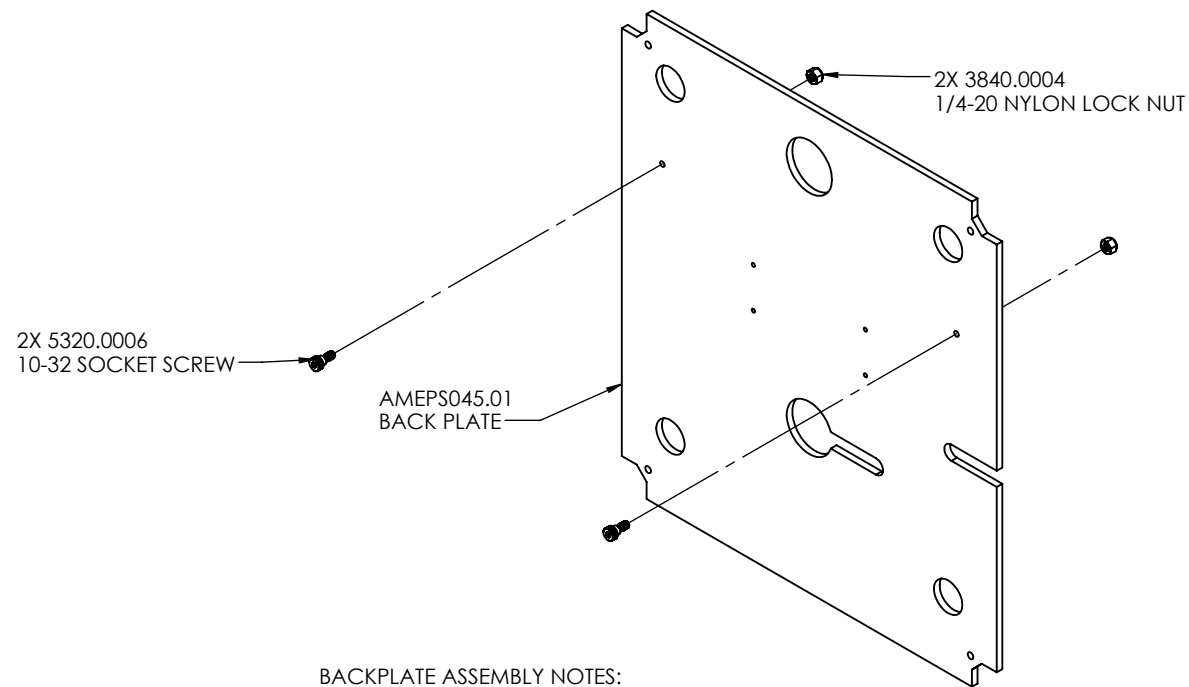

BACKPLATE ASSEMBLY NOTES:

1. THREAD THE TWO 5320.0006 SHOULDER SCREWS INTO THE BACKPLATE AND MAKE SURE THE AXIS OF THE SCREW REMAINS PERPENDICULAR TO THE BACKPLATE.
2. USE TWO NYLON LOCK NUTS TO TIGHTEN THE SHOULDER SCREWS ONTO THE BACKPLATE.

SURGE SUPPRESSOR

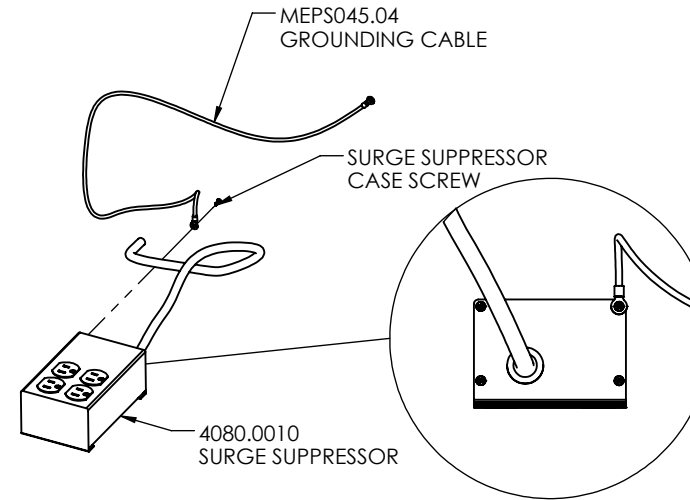

SURGE SUPPRESSOR ASSEMBLY NOTES:

1. ATTACH THE MEPS045.04 GROUND CABLE TO THE METAL FRAME ON THE BACK SIDE OF THE SUPPRESSOR WITH ONE OF THE PROVIDED SCREWS - SEE DETAIL
2. PACKAGE SURGE SUPPRESSOR ASSEMBLY SEPARATELY FOR SHIPMENT

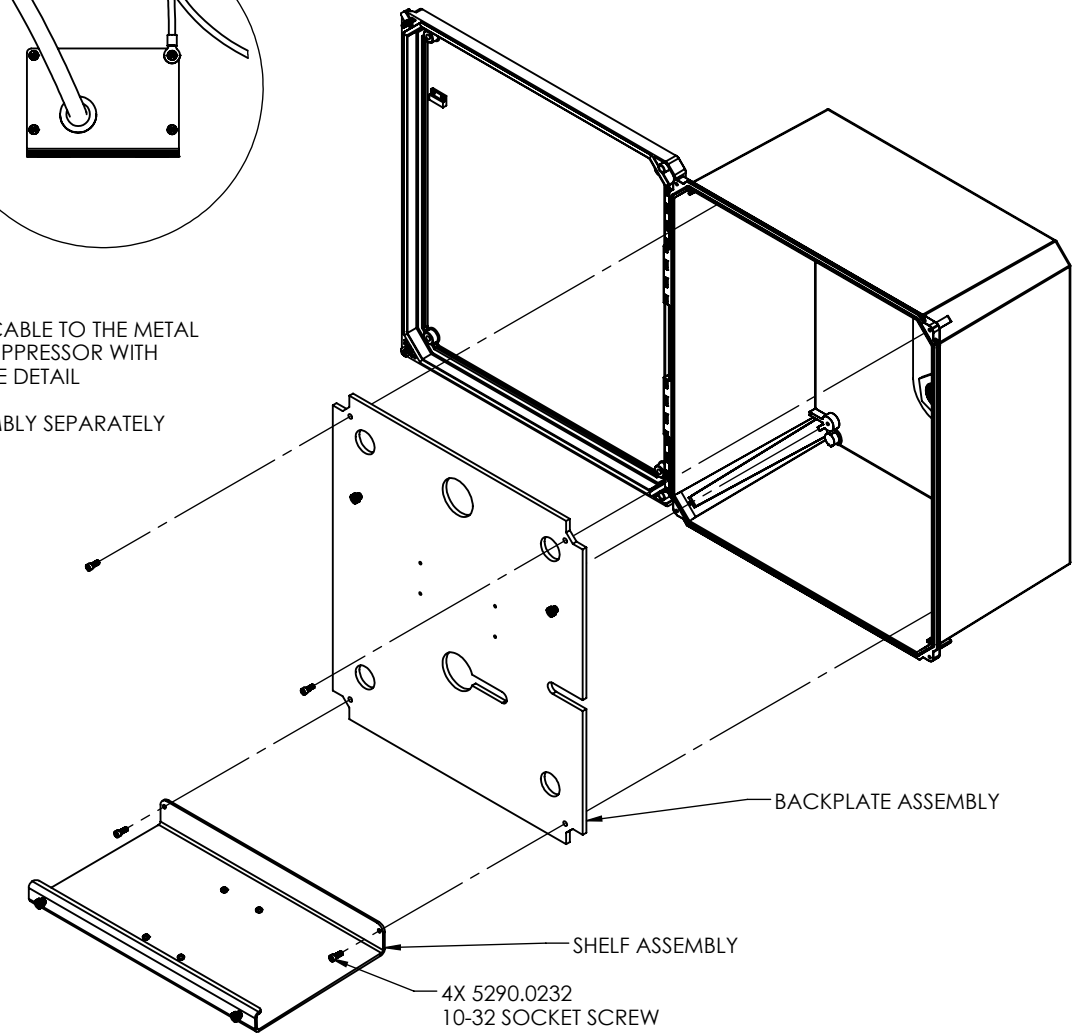

ASSEMBLY NOTES:

1. ATTACH THE BACKPLATE AND SHELF ASSEMBLIES TO THE CASE WITH THE 5290.0117 SCREWS USING A 4MM HEX DRIVER.
2. PACKAGE THE BUSHINGS, WASHERS, AND DISTRIBUTION PLATE FOR SHIPMENT.

SOLAR POWER SYSTEM

SHELF ASSEMBLY

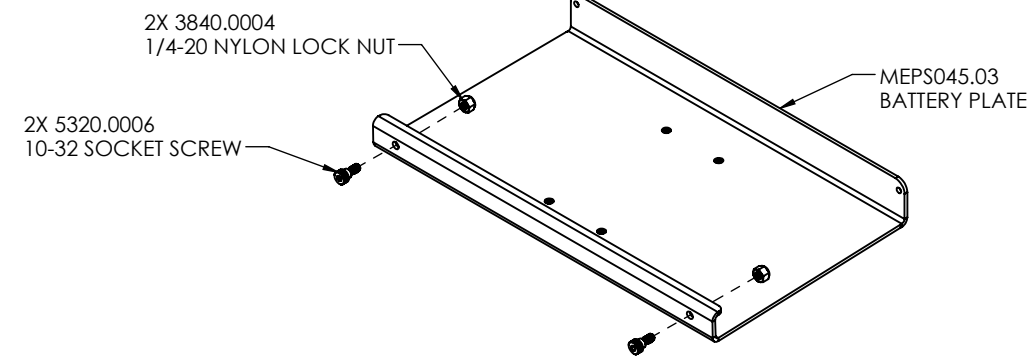

ASSEMBLY NOTES:

1. THREAD THE TWO 5320.0006 SHOULDER SCREWS THROUGH THE BATTERY PLATE AND LOCK IN PLACE WITH THE 3840.0004 NYLON LOCK NUT. TIGHTEN HAND TIGHT.

BACKPLATE ASSEMBLY

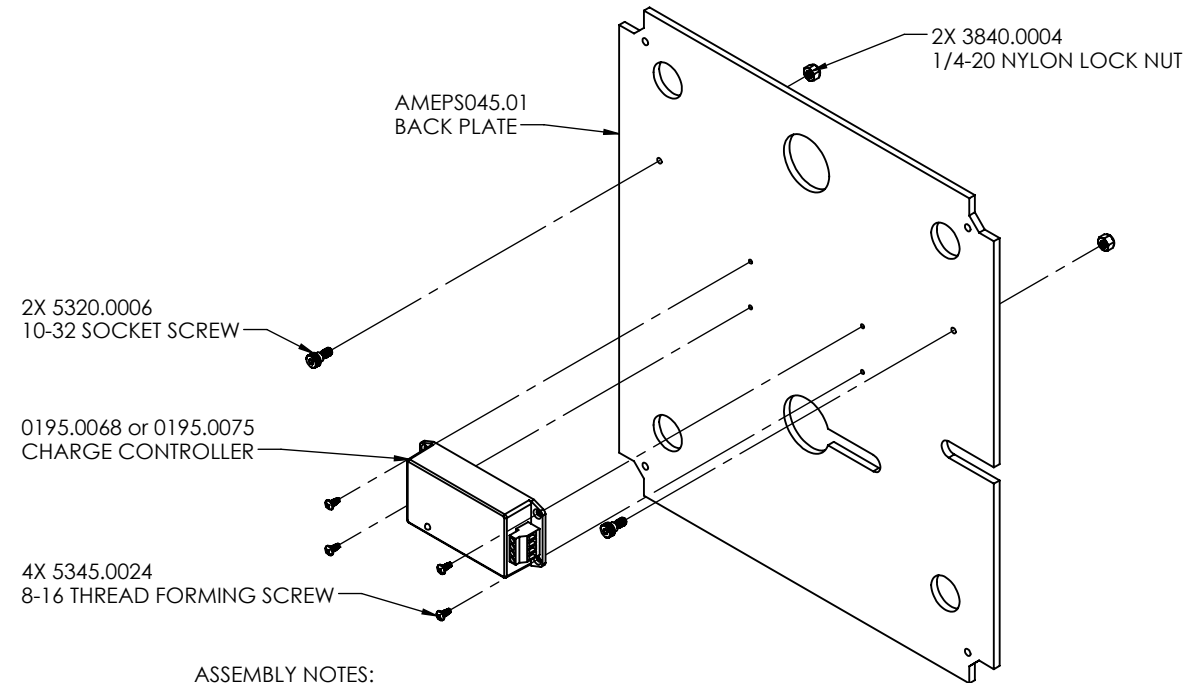

ASSEMBLY NOTES:

1. THREAD THE TWO 5320.0006 SHOULDER SCREWS INTO THE BACKPLATE AND MAKE SURE THE AXIS OF THE SCREW REMAINS PERPENDICULAR TO THE BACKPLATE.
2. USE TWO NYLON LOCK NUTS TO TIGHTEN THE SHOULDER SCREWS ONTO THE BACKPLATE.
3. CHECK AGAINST ORDER TO ENSURE THAT THE CHARGE CONTROLLER, 0195.0068 OR 0195.0075, IS CORRECT FOR THE ORDER AND MATCHES THE BATTERY TYPE.
4. ATTACH THE CHARGE CONTROLLER TO THE BACKPLATE USING THE FOUR 5345.0024 SCREWS.

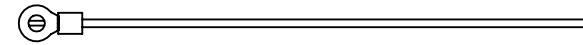

PACKAGE MEPS045.10 GROUNDING CABLE SEPARATELY FOR SHIPMENT

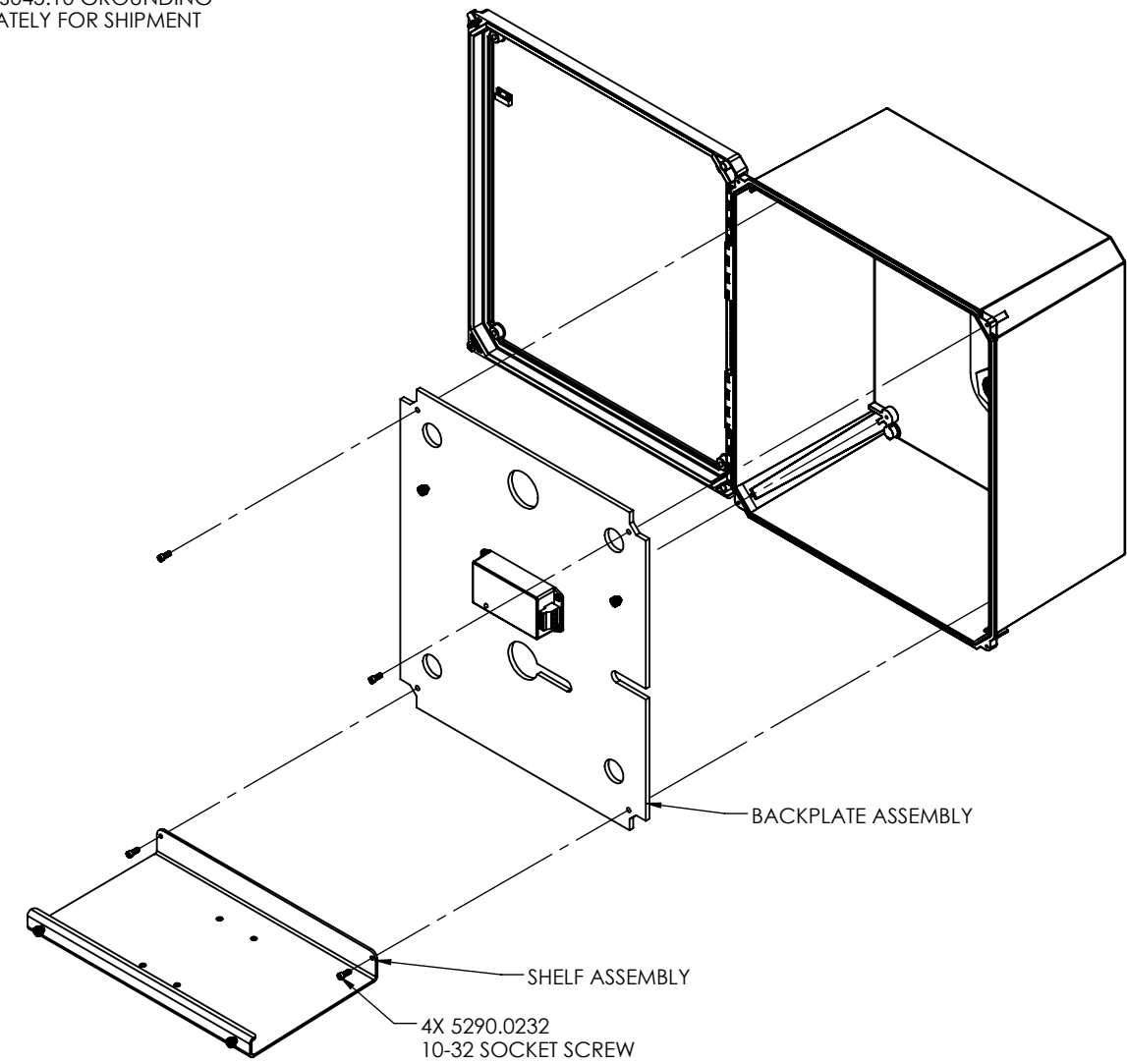

ASSEMBLY NOTES:

1. ATTACH THE BACKPLATE AND SHELF ASSEMBLIES TO THE CASE WITH THE 5290.0117 SCREWS.
2. PACKAGE THE BUSHINGS, WASHERS, AND DISTRIBUTION PLATE FOR SHIPMENT.